

HOLE LAYOUT OF STANDARD DOOR HARDWARE

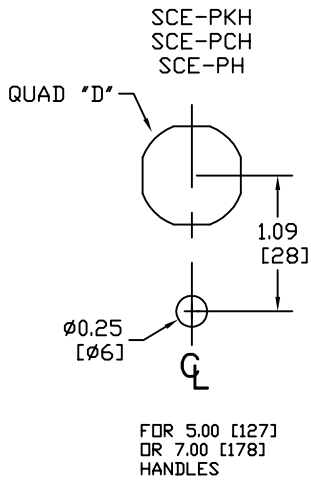

- | | | |
|-----------|-----------|-----------|
| SCE-DLWKC | SCE-PLHG | SCE-KLWN |
| SCE-DLWKF | SCE-DLSSB | SCE-DL7TE |
| SCE-DL7SC | SCE-DLSB | SCE-ELPL |
| SCE-DLCA | SCE-NLTH | SCE-ELKL |
| SCE-DLKLD | SCE-DLSBB | SCE-PLWKB |
| | | SCE-KLWNB |

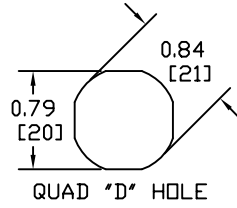

1.25 [32] OFF THE INSIDE
FLANGE TO THE CENTER OF THE
LATCH.

ENVIROLINE ENCLOSURES WITH
0.88 [22] FLANGE, 2.06 [52] OFF
EDGE OF DOOR TO CENTER OF
LATCH.

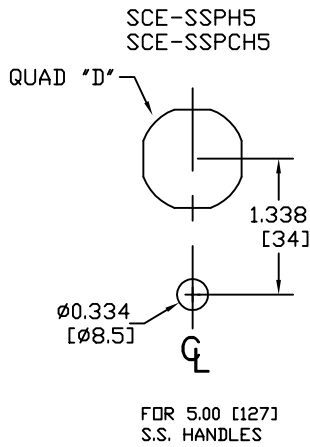
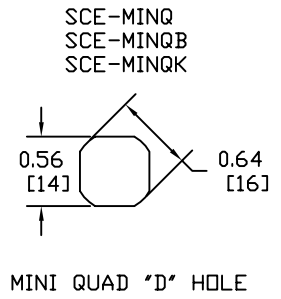

SCE-FSH2, FSH4, FSH6, &
FSH8 FLUSH SWING

